

RGH GI Space - Conceptual Plan for Proposed Space Development

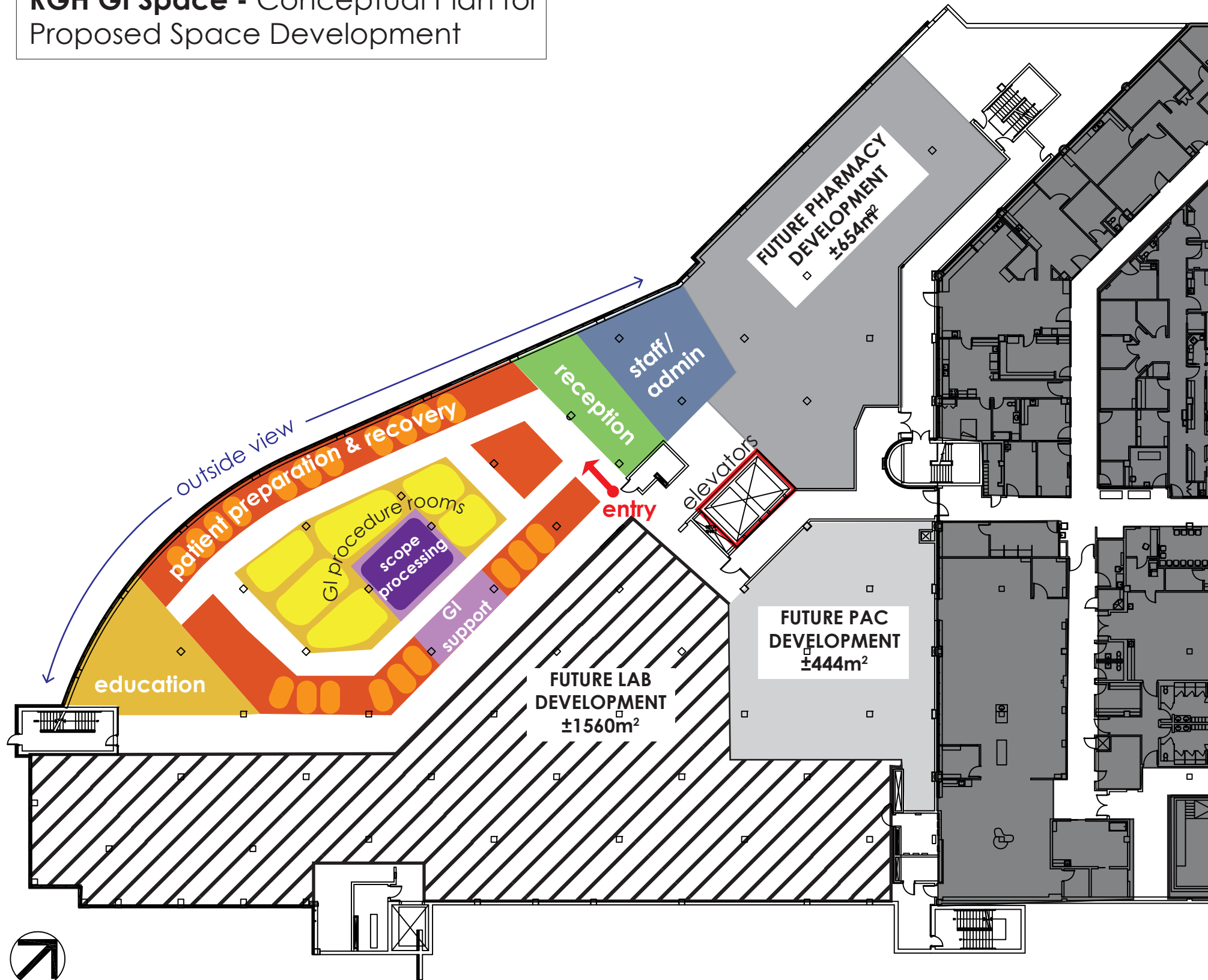

Major functions of GI Clinic	Total NSM	Total SF
1.0 Reception & Waiting	47.5	511
2.0 GI Procedure Rooms • endoscopy (bronchoscopy) rooms (6) • ultrasound & isolation room • dictation & support areas	243.3	2,619
3.0 Patient Preparation & Recovery • 20 patient bays & 4 w/c's • med room, consult room	203.2	2,187
4.0 GI Support Areas • scope reprocessing • clean storage/dirty utility rooms	73.0	786
5.0 Staff/Admin Area • offices & team room • staff room & lockers	60.7	653
Total Area Net (SM and SF)	627.7	6,757
Total Area with Circulation	916.4	9,865

NOTE:

Space allocated to specific functions were calculated using current Alberta Health and INFRA space guidelines. All areas shown are proportionally correct to correspond to the Master Program for the GI Clinic.

Room-specific layouts of the program space (a schematic design) will proceed in subsequent architectural design phases



NORTH